

HTO

CILINDRO TUFFANTE STANDARD
STANDARD PLUNGER CYLINDER

Series M250

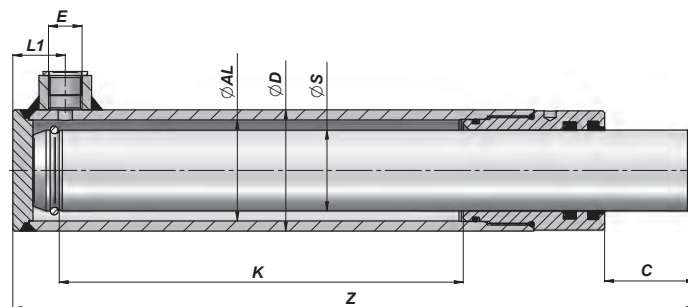
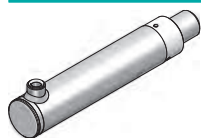

Codice Code	K	Z	kg	E BSP	L1	C
ØD 50 ØAL 40 ØS 30						
HT02300200	200	326	3,67	3/8"	23	40
HT02300250	250	376	4,22			
HT02300300	300	426	4,78			
HT02300350	350	476	5,33			
HT02300400	400	526	5,89			
HT02300500	500	626	7,00			
ØD 60 ØAL 50 ØS 40						
HT03400200	200	338	5,67	3/8"	26	45
HT03400300	300	438	7,34			
HT03400400	400	538	9,00			
HT03400500	500	638	10,67			
HT03400600	600	738	12,35			
ØD 70 ØAL 60 ØS 50						
HT04500300	300	450	10,60	3/8"	30	50
HT04500400	400	550	12,94			
HT04500500	500	650	15,28			
HT04500600	600	750	17,62			

MATERIALE TUBO: ACCIAIO St 52.3 DIN 2393 ISO H9
TUBE MATERIAL : STEEL St 52.3 DIN 2393 ISO H9

MATERIALE ASTA: ACCIAIO UNI C45 SAE 1045 CROMO 25 MICRON ±5 Rating 9 / 120 h ISO 10289 - 1999/ISO 9227-NSS
ROD MATERIAL : STEEL UNI C45 SAE 1045 CHROME 25 MICRON ±5 Rating 9 / 120 h ISO 10289 - 1999/ISO 9227-NSS

CARATTERISTICHE TECNICHE : VEDI PAGINA 40 - TECHNICAL SPECIFICATIONS : SEE PAGE 40

CARATTERISTICHE TECNICHE TECHNICAL SPECIFICATIONS

TYPE "HTO"

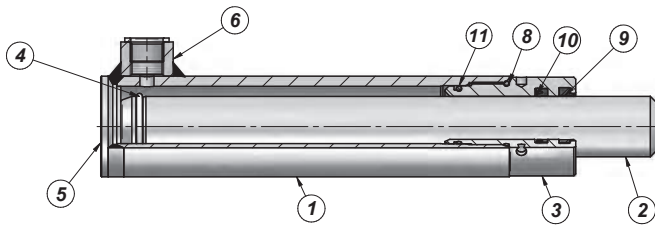

"HTO" Pressione Massima - Max. Pressure: 250 Bar (**)

TYPE "HFRT"

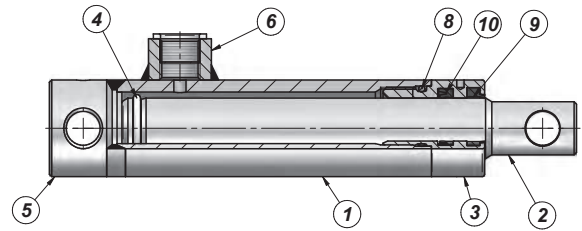

"HFRT" Pressione Massima - Max. Pressure: 250 Bar (**)

PRODOTTO - PRODUCT			MATERIALE - MATERIAL	
1	TUBO LUCIDO POLISHED TUBE		ACCIAIO: S1 52.3 DIN 2393 ISO H9 STEEL: S1 52.3 DIN 2393 ISO H9	
2	STELO CROMATO CHROMED ROD		ACCIAIO: UNI C45 - SAE 1045 - CROMO 25 Micron ±5 Rating 9 / 120 h ISO 10289 - 1999/ISO 9227-NSS STEEL: UNI C45 - SAE 1045 - CHROME 25 Micron ±5 Rating 9 / 120 h ISO 10289 - 1999/ISO 9227-NSS	
3	TESTATA DI GUIDA HEAD BUSH	TIPO : "HTO" TYPE: "HTO"	GHISA: EN-GJL 250 (G25-UNI 5007 / EN 1561) HYDRAULIC CAST IRON: EN-GJL 250 (G25-UNI 5007 / EN 1561)	
3	TESTATA DI GUIDA HEAD BUSH	TIPO : "HFRT" TYPE: "HFRT"	ACCIAIO: 9SMn28 CON TRATTAMENTO "NI-TEMPER" STEEL: 9SMn28 WITH "NI-TEMPER" TREATMENT	
4	ANELLO DI ARRESTO STOP RING		ACCIAIO: 9SMn28 STEEL: 9SMn28	
5	FONDELLO END PLUG		ACCIAIO: S355J0 (Fe510C) - S355JR (A105) STEEL: S355J0 (Fe510C) - S355JR (A105)	
6	BORCHIA FILETTATA THREADED PORT		ACCIAIO STEEL	
8	GUARNIZIONE: O-RING SEAL: O-RING	TIPO : "HTO" TYPE: "HTO"	NBR 70 SHORE NBR 70 SHORE	
8	GUARNIZIONE: O-RING SEAL: O-RING	TIPO : "HFRT" TYPE: "HFRT"	NBR 90 SHORE NBR 90 SHORE	
9	GUARNIZIONE: GHK SEAL: GHK		POLIURETANO POLYURETHANE	
10	GUARNIZIONE: TSE-TTS-TTI/L SEAL: TSE-TTS-TTI/L		TSE: NBR+TESSUTO TTS-TTI/L: POLIURETANO TSE: NBR+FABRIC TTS-TTI/L: POLYURETHANE	
11	GUARNIZIONE: O-RING SEAL: O-RING		NBR 70 SHORE NBR 70 SHORE	

Velocità Limite - Top Speed: max 0,5 m/s Temperatura C° - Temperature C°: -25°C - +80°C

(**) Il dato della pressione è sempre da verificare in base all'applicazione del cilindro.

(**) The pressure value is always to be checked depending on the application of the cylinders.

CARATTERISTICHE TECNICHE
TECHNICAL SPECIFICATIONS

FORZA IN SPINTA - *OUTPUT FORCE* (HT0)

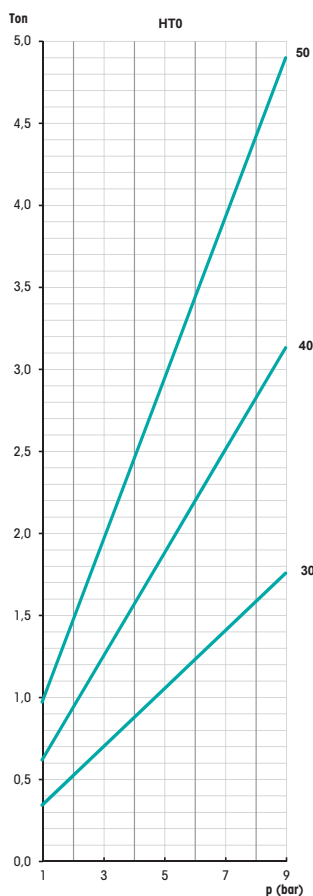

FORZA IN SPINTA - *OUTPUT FORCE* (HFRT)

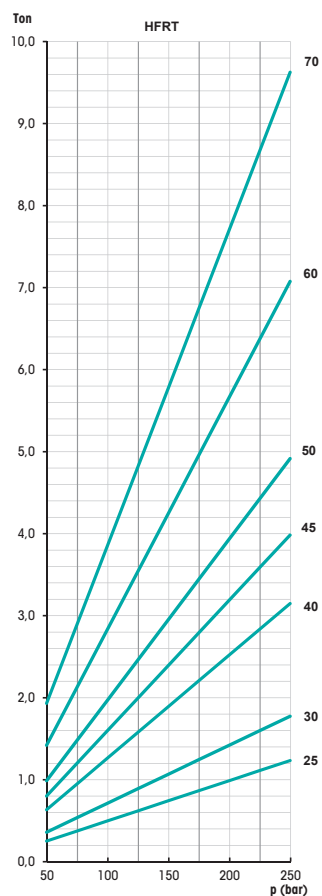

PRESSOFLESSIONE - *BUCKLING* (HT0)

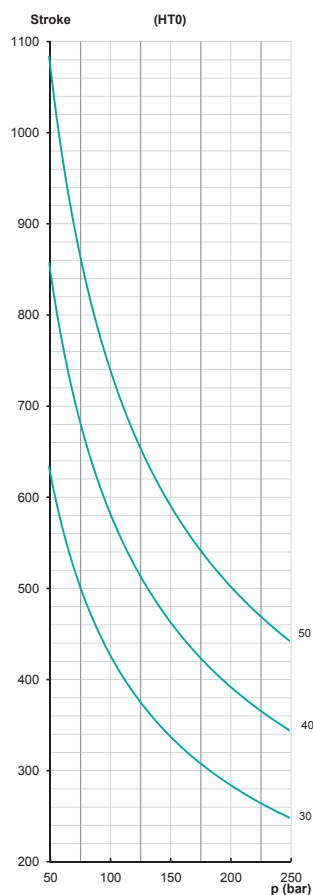

PRESSOFLESSIONE - *BUCKLING* (HFRT)

